

# Bronze Terminal Lugs - Two or Four Hole Tongue Type P2NL

For use with two copper conductors

- Manufactured from high strength copper alloy for maximum conductivity and corrosion resistance
- Used for joining a wide range of copper conductors to equipment pads or bus bars
- Plated steel set screw provides high strength connection
- Two and four hole mounting pads allow for maximum surface contact in heavy duty applications
- Annular serrations in conductor grooves provide improved mechanical performance
- Inspection hole allows for visual confirmation of proper cable insertion
- Lug can be furnished electro-tin or silver plated
- For tin plating, suffix catalog number with "-TN", "-SV" for silver plating

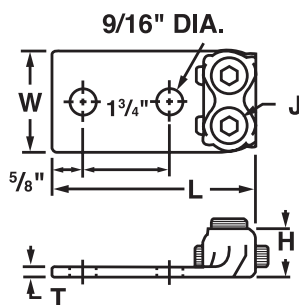

Fig. 1

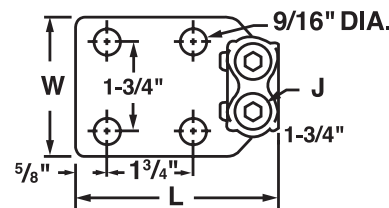

Fig. 2

CATALOG NUMBER	FIG. NO.	CONDUCTOR RANGE	APPROXIMATE DIMENSIONS (IN.)					HEX SIZE
			H	L	T	W	J (SCREW THREAD)	
P2NL-1/0-2N	1	8 Sol. - 1/0 Str.	.84	3.88	.31	1.50	1/2 - 20	1/4
P2NL-1/0-4N	2		.84	3.88	.25	3.00	1/2 - 20	1/4
P2NL-250-2N	1	6 Sol. - 250 kcmil	1.13	4.00	.31	1.75	3/4 - 16	3/8
P2NL-250-4N	2		1.13	4.00	.25	3.00	3/4 - 16	3/8
P2NL-500-2N	1	4 Sol. - 500 kcmil	1.47	4.50	.38	2.50	1 5/16 - 16	3/8
P2NL-500-4N	2		1.47	4.50	.31	3.00	1 5/16 - 16	3/8
P2NL-1000-2N	1	500 - 1000 kcmil	2.00	4.88	.50	3.00	1 3/8 - 14	3/8
P2NL-1000-4N	2		2.00	4.88	.50	3.00	1 3/8 - 14	3/8